

## SA/SF6-28 front-nut mount panel socket assembling instruction-Solder

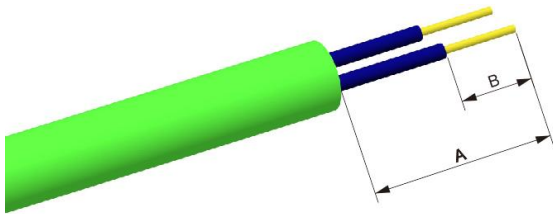

| Series   | A (mm) | B (mm) |
|--|--------|--------|
| SA6/SF6/SA8/SF8  | 10     | 4      |
| SA10/SF10/SA12/SF12/SA16/SF16/SA20/SF20/SF24/SA24/SA28 | 20     | 5      |

① Strip length as listed above

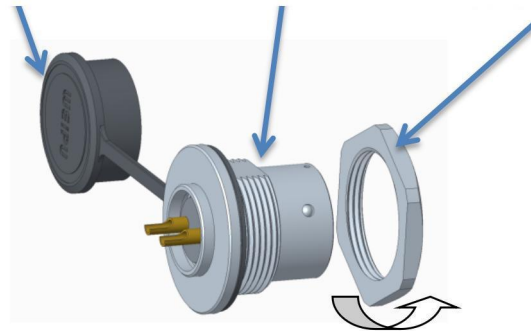

② Unscrew the locknut

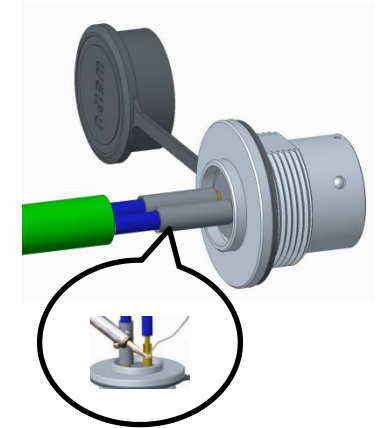

③ Put the stripped cable through the locknut and panel based on above panel cutout size

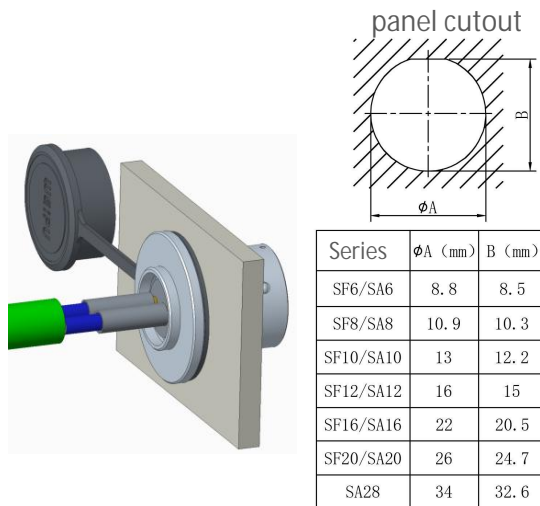

| Series    | φA (mm) | B (mm) |
|-----------|---------|--------|
| SF6/SA6   | 8.8     | 8.5    |
| SF8/SA8   | 10.9    | 10.3   |
| SF10/SA10 | 13      | 12.2   |
| SF12/SA12 | 16      | 15     |
| SF16/SA16 | 22      | 20.5   |
| SF20/SA20 | 26      | 24.7   |
| SA28      | 34      | 32.6   |

④ Tighten the socket body and panel closely

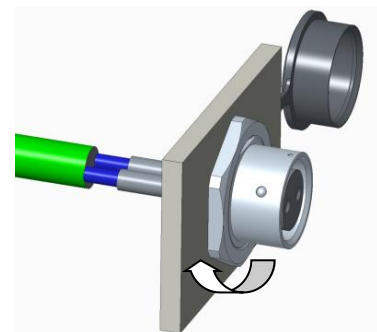

⑤ Tighten the locknut according to torque in the table.

| Series                    | locknut torque (N.M) |
|---------------------------|----------------------|
| SF6/SA6/SF8/SA8/SF10/SA10 | 0.15-0.2             |
| SF12/SA12                 | 0.3-0.5              |
| SF16/SA16                 | 0.8-1.0              |
| SF20/SA20/SF24/SA24/SA28  | 1.0-1.1              |

| Series                             | panel thickness |
|------------------------------------|-----------------|
| SF6/SA6/SF8/SA8                    | 2max            |
| SF10/SA10                          | 3.5max          |
| SF12/SA12/SF16/SA16/SF20/SA20/SA28 | 4max            |