

## ST1214、WY12-ZZ Square flange mount Socket Assembling Instruction-Solder

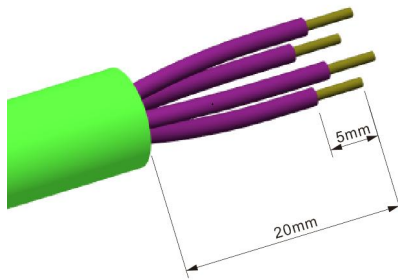

Strip length

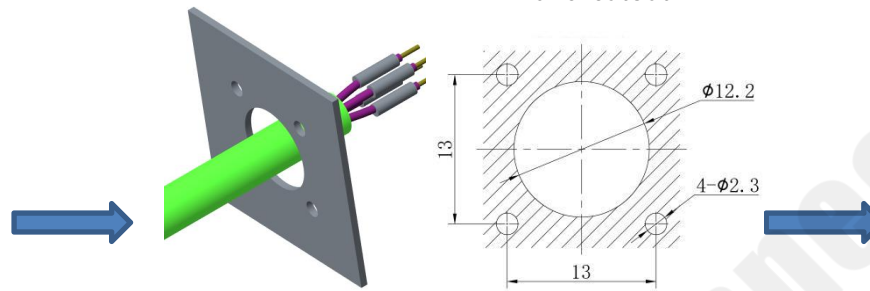

② Put the stripped wire through the panel

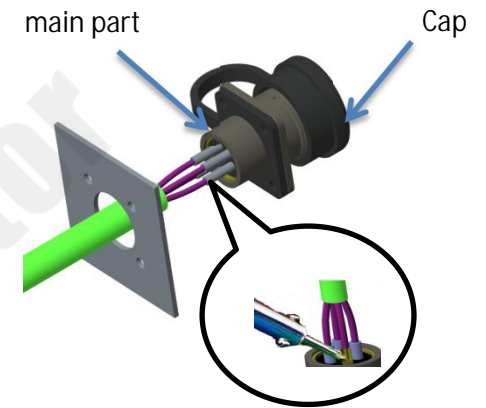

Solder the wire to the contact and wrap with heat shrinkable tube after soldering.

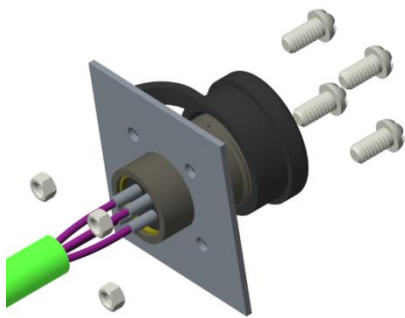

④ Install the socket on the panel closely

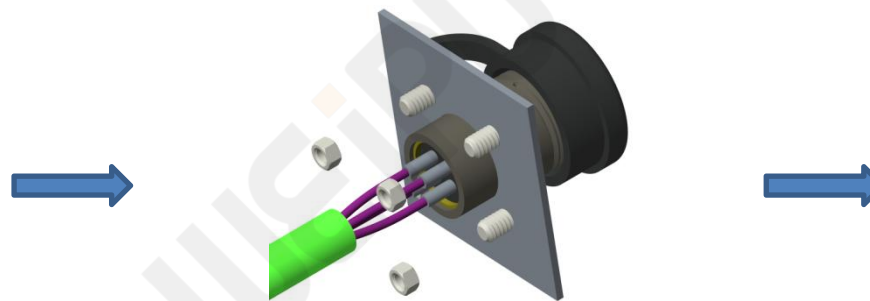

⑤ Install screws

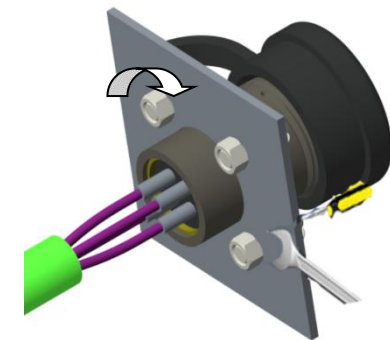

⑥ Tighten the Iscrew nut with torque of 0.3-0.5N.m