

## ST1213、 WY12-ZMQ Front-nut mount Socket Assembling Instruction-Solder

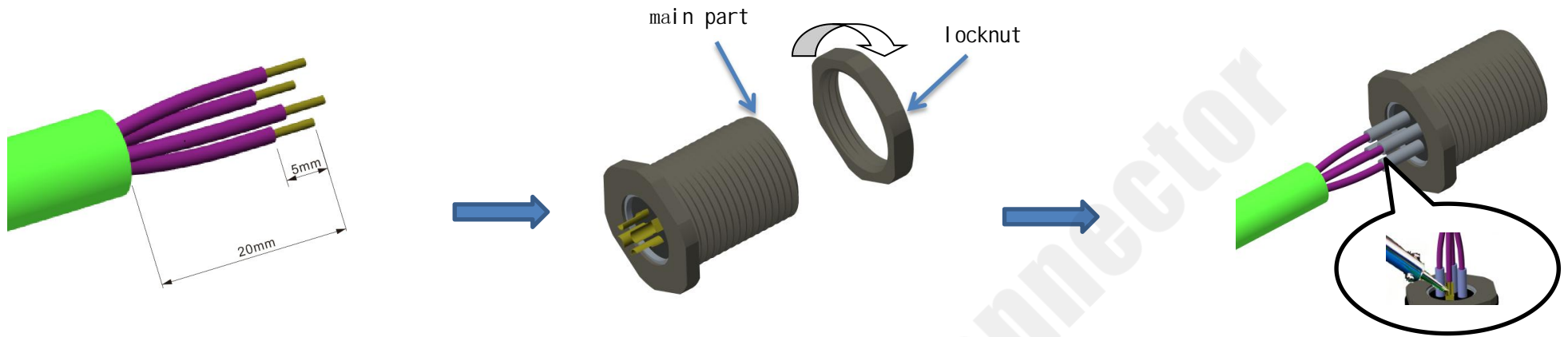

① Strip length

② Unscrew the locknut

Solder the wire to the contact and wrap with heat shrinkable tube after soldering.

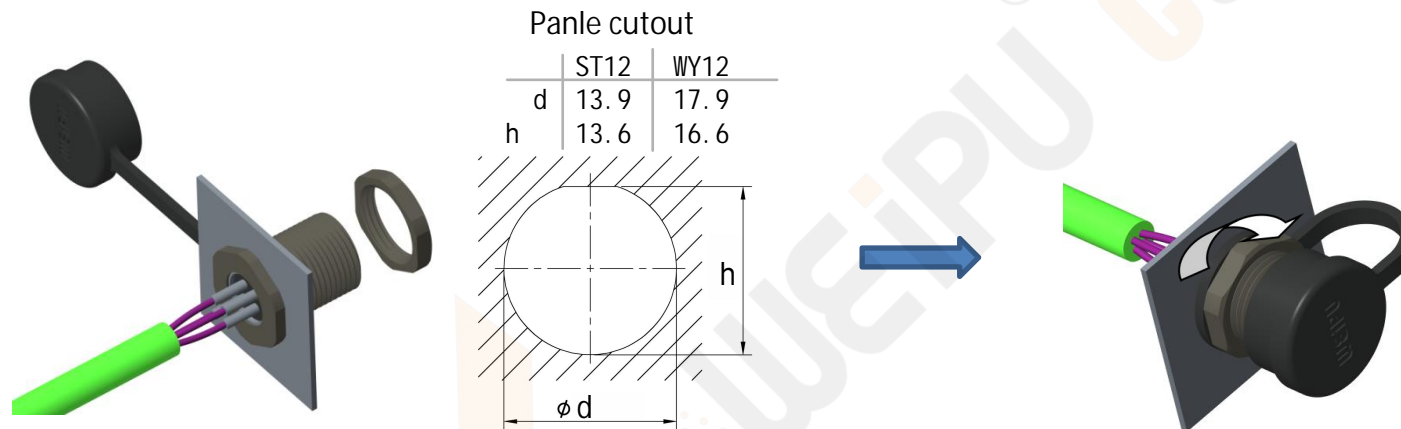

④ Install the socket on the panel closely  
(Panel thickness: 8mm max)

⑤ Tighten the locknut with torque of 0.3-0.5N.m