

SA/SF16-28 cable plug assembling instruction-Solder

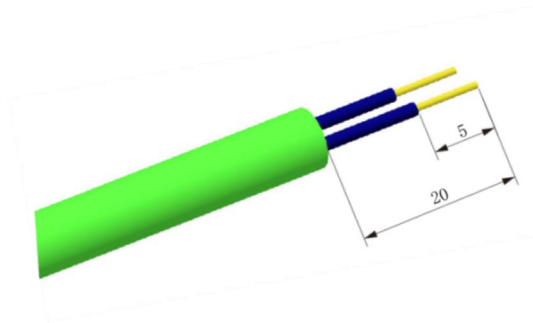

① SA/SF20-28 Strip length

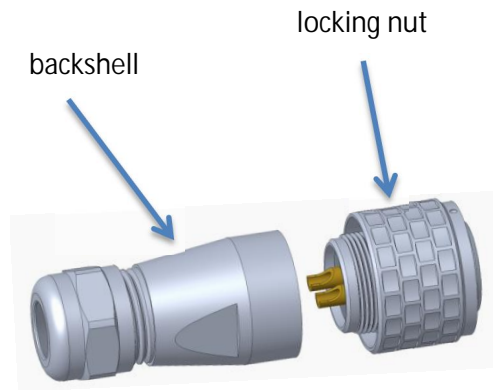

② Apart the backshell and main part

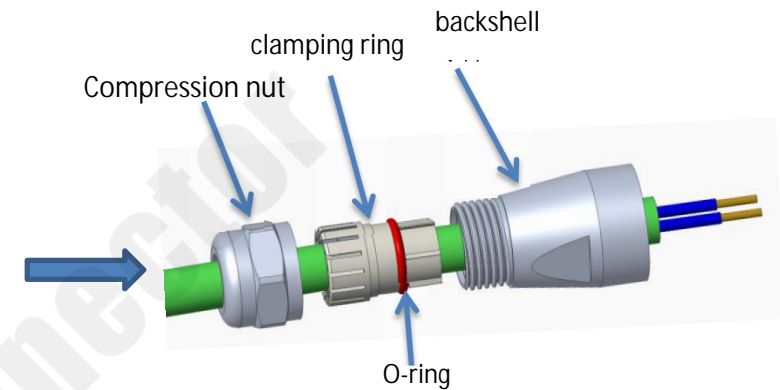

③ Put the stripped cable through all parts

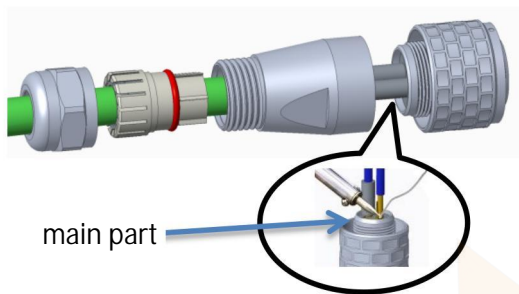

④ Solder the wire to the contact and wrap with heat shrinkable tube after soldering

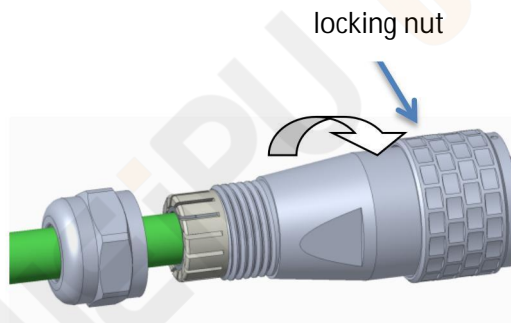

⑤ Tighten the backshell and the main part clockwise with torque of 1.0-1.2N.m (fix the plug by mating with socket)

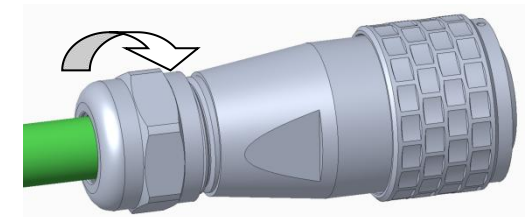

⑥ Tighten the compression nut and the backshell clockwise according to torque of 1.2-1.4N.m