

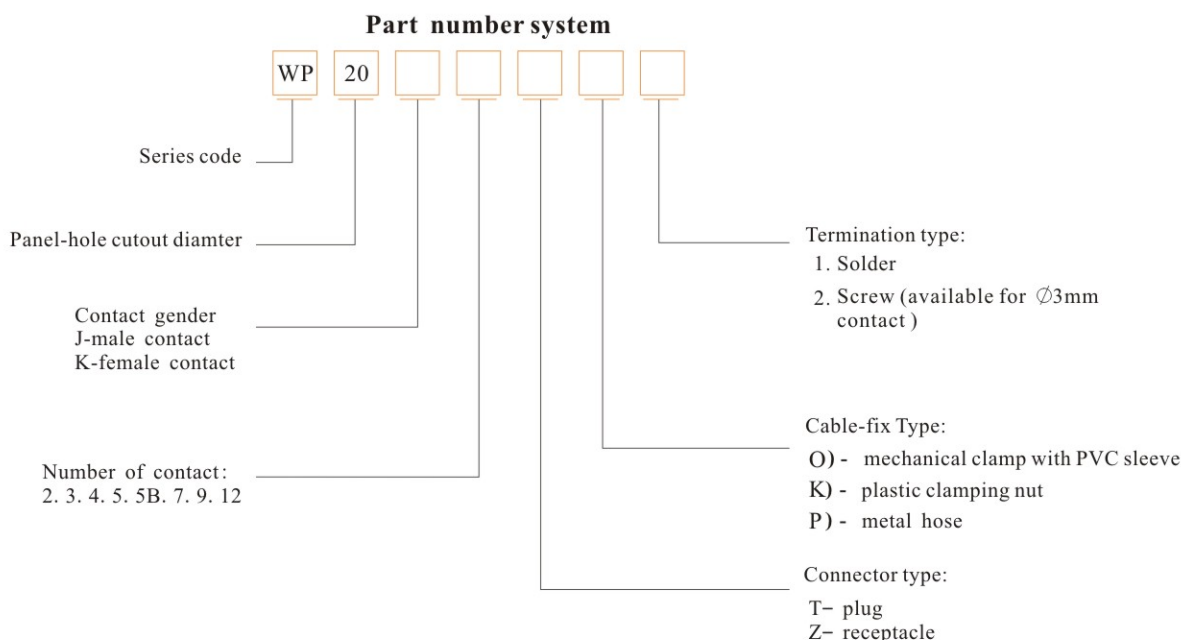

● WP20 Series



The plugs and receptacles are available with male contact or female contact

Material and spec

Coupling	Bayonet
Shell	Nylon PA66/zinc alloy
Insert material	PPS max temperature 260 °C
Contact material	Brass
Contact plating	Gold over nickel
Termination	2-5 contacts solder , 7-12 contacts solder / screw
Mating cycle	>500
Temperature range	-25°C~+85°C



● Receptacle: Z IP44

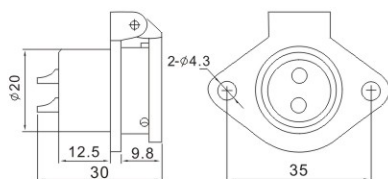

● Panel cutout

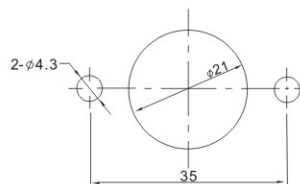

● Mechanical clamp with PVC sleeve : TO

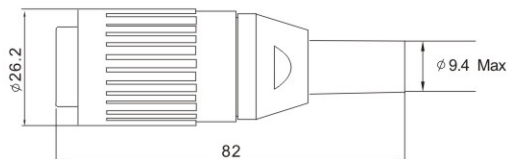

● Metal hose: TP

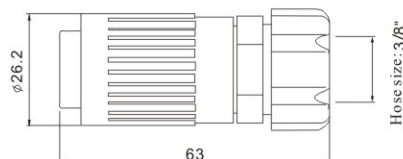

● Plastic clamping nut : TK IP55

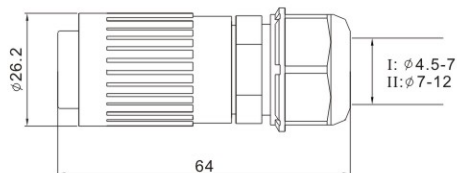

Contact arrangement and spec

Number of contact	2	3	4	5	5B	7	9	12
Male contact face view								
Rated current(A)	30A	30A	30A	30A	5A, 30A	15A	5A	5A
Contact diameter	∅ 3X2	∅ 3X3	∅ 3X4	∅ 3X5	∅ 1X3 ∅ 3X2	∅ 2X7	∅ 1X9	∅ 1X12
Rated voltage (AC.V)	500V	500V	500V	500V	500V	500V	500V	400V
Test voltage(AC.V) 1 min	1500V	1500V	1500V	1500V	1500V	1500V	1500V	1200V
Contact resistance mΩ	1	1	1	1	5、1	2.5	5	5
Insulation resistance mΩ	2000	2000	2000	2000	2000	2000	2000	2000
Termination	solder / screw solder / screw solder / screw solder / screw solder / screw					solder	solder	solder
Wire size ^{mm²} /AWG	≤4.17/11	≤4.17/11	≤4.17/11	≤4.17/11	≤0.785/18 ≤4.17/11	≤2/14	≤0.785/18	≤0.785/18